

Filed for Record in:  
SMITH COUNTY, TEXAS  
JUDY CARNES, COUNTY CLERK  
On Jan 05 2004  
At 4:06pm  
Recording #: 295412  
Doc/Num: 2004-0000350  
Doc/Type: PLT  
Deputy -Rebecca Calderon



1"=100'

**FINAL PLAT**  
**THE RESERVE**  
Smith County, Texas  
263.183 Acres, 195 Lots  
Sheet 4 of 9

PREPARED FOR:  
**Mark Mahaffey**  
1910 E.S.E. Loop 323 PMS 281  
Tyler, Texas 75701

**Vannoy & Assoc., Inc.**  
Surveyors/Planners  
105 Jordan Plaza Blvd., Suite 107  
Tyler, Texas 75704, (903)592-9920  
Waco, Texas 76710, (254)751-1934  
© Copyright 2004 Vannoy & Assoc., Inc. The content, color, and style of this plat prepared by copyright and all rights are reserved.

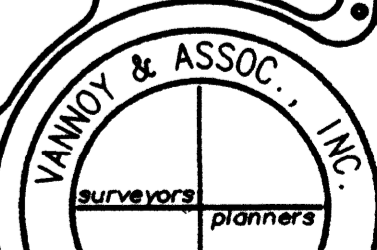

NOTICE: Setting a portion of this addition by meter and handle is a violation of the city ordinance and state law and is subject to fines and work stoppage of utilities and building permits.

TRUE AND CORRECT  
COPY OF ORIGINAL  
FILED IN SMITH COUNTY  
CLERK'S OFFICE

Drawn By: mjb  
Vannoy Job No.: 0308-012

**D/220-A**