

CALLLED 80.42 ACRES
BOYD LYNN HAMILTON ET UX
1260-342

JACOB HERRIN SURVEY, A-422

Approximate Location of Survey Line

MATTHEW COLWELL SURVEY, A-186

Filed for Record in
SMITH COUNTY, TEXAS
JUDY CHANES, COUNTY CLERK
On Jan 15 2004
Receipt # 25512
Doc/Num: 2004-000350
Doc/Type: Plat
Deputy: Rebecca Callerton

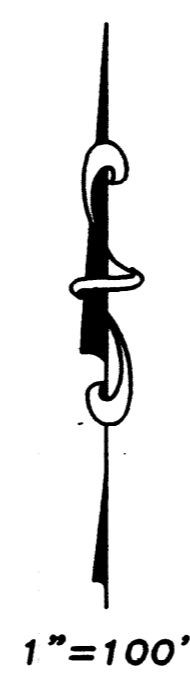

FINAL PLAT
THE RESERVE
Smith County, Texas
263.183 Acres, 195 Lots
Sheet 7 of 9

PREPARED FOR:
Mark Mahaffey
1910 E.S.E. Loop 323 PMS 285
Tyler, Texas 75701

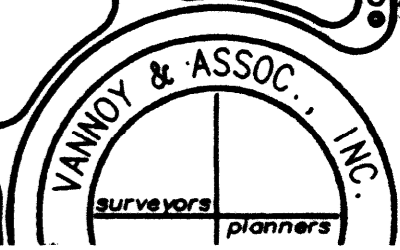

NOTICE: Selling a portion of this addition by metes and bounds is a violation of the city ordinance and state law and is subject to fine and withholding of utilities and building permits.

TRUE AND CORRECT
COPY OF ORIGINAL
FILED IN SMITH COUNTY

Drawn By: mjb
Vannoy Job No.: 0308-012